

**Tool model**  
**Tool Status**

MIIIFN  
active

**BOSTITCH®**

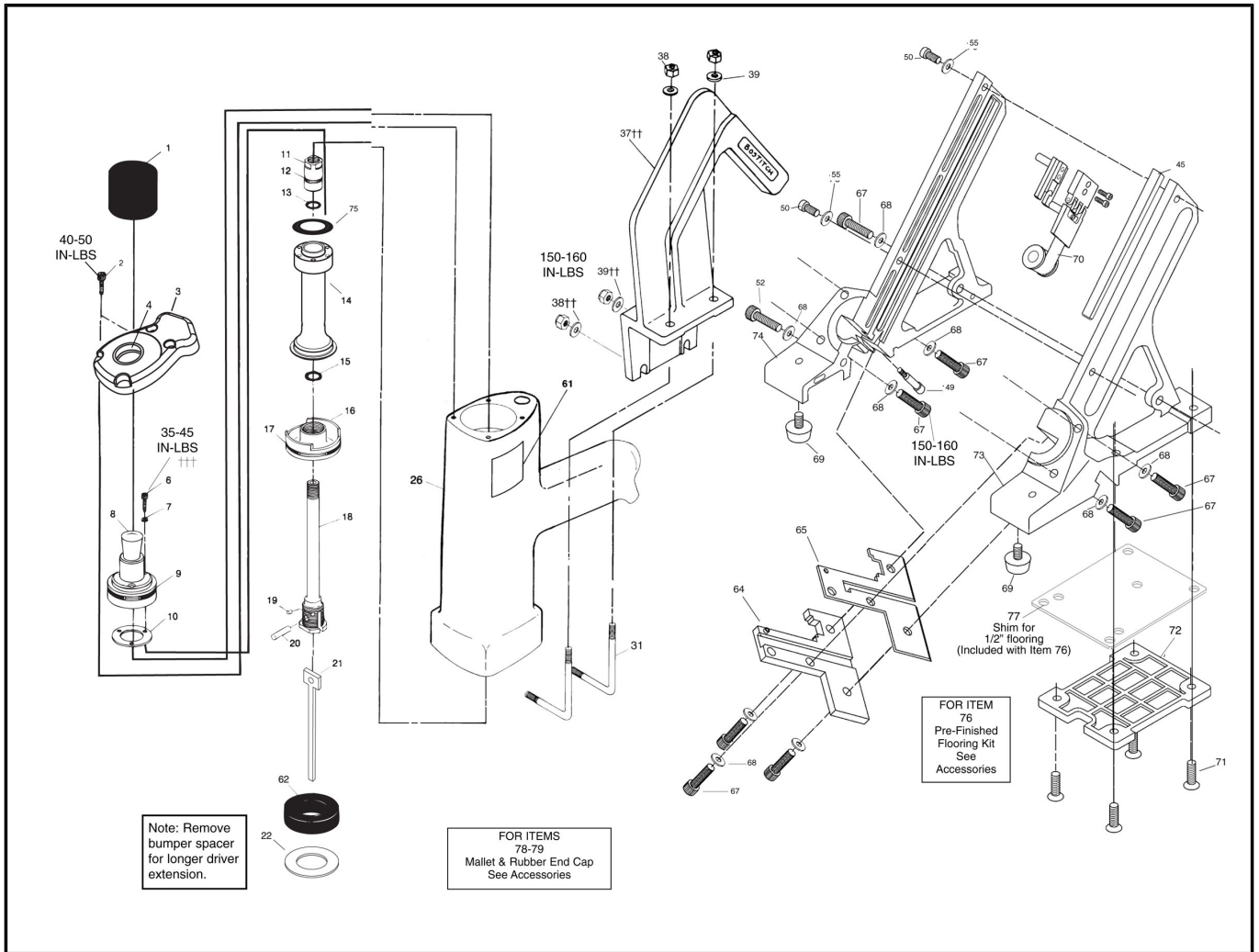

Chart Ref	Spare part code	Description	Status	Previous Part Code 1	Previous Part Code 2
1	<a href="#">87502</a>	HAMMER FACE	active		
2	<a href="#">UA3810.4</a>	SCREW,10-24 X 5/8 SHCS	active		
3	<a href="#">117524</a>	CAP,FRAME	active		
4	<a href="#">88445</a>	O-RING,.984X.139	active		
6	<a href="#">UA2810</a>	#8-32 X 5/8" SOC. HD. CAP SCREW	active		
7	<a href="#">LW8.2</a>	WASHER, LOCK	active		
8	<a href="#">BC1295</a>	POPPET ACTUATOR	active		
9	<a href="#">86460</a>	O-RING,1.859X.139	active		
10	<a href="#">180256</a>	GASKET,POPPET PISTON	active	<a href="#">BC701</a>	
11	<a href="#">BC703</a>	PLUNGER	active		
12	<a href="#">850144</a>	O-RING,.614X.070	active		
13	<a href="#">86458</a>	O-RING 1/16" X 1/2" ID	active		
14	<a href="#">121800</a>	POPPET	active		
15	<a href="#">850143</a>	O-RING,.487X.103	active		
16	<a href="#">BC1175</a>	DRIVER PISTON	active		
17	<a href="#">850626</a>	O-RING,1.984X.139	active		
18	<a href="#">BC1455</a>	PISTON STEM	active		
19	<a href="#">BC347</a>	NYLON INSERT	active		
20	<a href="#">UB4112.3</a>	PIN, DOWEL .250 X .75	active		
21	<a href="#">107165</a>	DRIVER BLADE	active		

Chart Ref	Spare part code	Description	Status	Previous Part Code 1	Previous Part Code 2
22	<a href="#">9R199632</a>	BUMPER	active	<a href="#">118076</a>	
26	<a href="#">BC1328AFS</a>	BODY	active		
31	<a href="#">BC1301</a>	CLAMP SCREW	active		
37	<a href="#">BC1619</a>	HANDLE, LONG	active		
38	<a href="#">HN1420.4</a>	NUT, ESN, 1/4-20	active		
39	<a href="#">PW14</a>	WASHER, 1/4 USS FLAT BLK Z	active		
45	<a href="#">180248</a>	NAIL SLIDE	active	<a href="#">107040</a>	
49	<a href="#">000000-00</a>	NO LONGER AVAILABLE	disc	<a href="#">107044</a>	
50	<a href="#">107166</a>	SCREW, SHCS, 10-24X3/4	active		
52	<a href="#">107161</a>	SCREW, SHCS, 1/4-20X2	active		
55	<a href="#">107163</a>	WASHER, 3/16 DIA.	active		
61	<a href="#">000000-00</a>	NO LONGER AVAILABLE	disc	<a href="#">851364</a>	
62	<a href="#">105043</a>	BUMPER	active		
64	<a href="#">107038</a>	DRIVER GUIDE	active		
65	<a href="#">180247</a>	WEAR PLATE	active	<a href="#">107039</a>	
67	<a href="#">UA4814.1</a>	1/4-20 X 7/8 SOC. HD. CAP SCREW	active		
68	<a href="#">107164</a>	WASHER, 1/4 DIA.	active		
69	<a href="#">107042</a>	PAD	active		
70	<a href="#">182184</a>	PUSHER ASSY	active	<a href="#">107041</a>	
71	<a href="#">107162</a>	SCREW, SFHCS, 1/4-20X5/8	active		
72	<a href="#">175794</a>	SPACER	active	<a href="#">107043</a>	
73	<a href="#">180244</a>	MAGAZINE LEFT SIDE	active	<a href="#">107036</a>	
74	<a href="#">180242</a>	MAGAZINE, RIGHT SIDE	active	<a href="#">107037</a>	
75	<a href="#">121799</a>	O-RING, 1.287 X .210	active		
76	<a href="#">MIIIFOOT-KIT</a>	KIT, PREFINISHED FLOORING	active		
77	<a href="#">159828</a>	SHIM, FOOT	active		
78	<a href="#">174236</a>	MALLET, 14.5 IN GRAPHITE	active	<a href="#">167193</a>	
79	<a href="#">000000-00</a>	NO LONGER AVAILABLE	disc	<a href="#">CL80-22541</a>	